



Roosevelt Island Garden Club

10/22/23 Fall Meeting



WELCOME BACK

to our 100% in-Person
2023 Fall Meeting



Club Secretary

- Quorum Verification – Quorum was reached by 7:00 p.m.
- Roll Call of Officers
- Approval of Minutes from March 19, 2023
General membership Spring meeting

2023 Board

Elected Positions



President
Neal Weissman



Vice President
Jack Burkhalter



Secretary
Julia Ferguson



Treasurer
Takelu Gross



Director
Dave Nisthaus



Director
Carolina Trujillo



Director
Kristin Carotenuto

Appointed Positions



**Landscape &
Common Areas**
Curtis Lowrey



Maintenance
Antoine Réveillon



Standards
Janet Linville



Compost



Outreach & Publicity



Rose Garden
Roisin O'Cearhaill

Agenda

- Welcome to the Fall Meeting
- Roll Call of Officers - Secretary
- Approval of Minutes from Spring General Membership Meeting
- Unfinished Business
- Election of Officers
- President's Reports
- VP's Reports – New Members, Waitlist, Community Service
- Secretary's Report
- Treasurer's Report
- Director's Reports – Associate Program, SLF
- Win tickets to the Museum of Natural history
- Committee Reports – Outreach, Standards, Compost, Maintenance, Landscape, Rose Garden
- New Business
- Closing of Meeting

Members' Map

Roosevelt Island
Garden Club

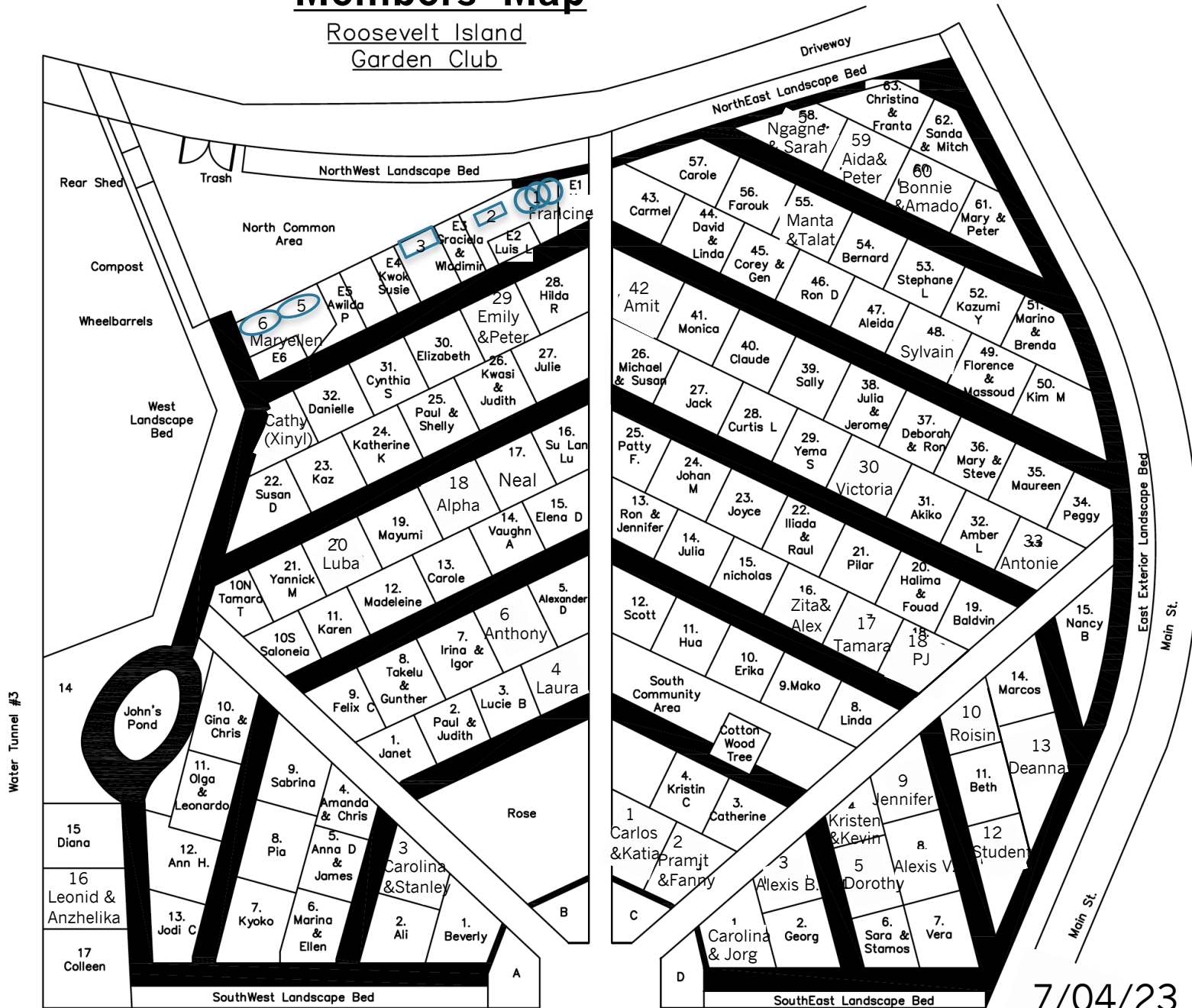

7/04/23

Positions for Election

- President:
 - Set agenda, lead meetings, manages calendar, sign annual RIOG contract, procurement officer, manage keys, lockers, and water supply
- VP:
 - Manage waitlist, supervise community service days, retain record of community service, assume the Presidential function when needed
- Secretary:
 - Maintain club email account, keep minutes of meetings, retain records and files, oversee website and tech support for meetings, manage membership applications system
- Treasurer:
 - Collect membership dues, keep record of expenses, issue checks, manage bank balance and PayPal, pay annual PO Box & insurance. Retain our tax free 501c3 status, and pass basic audit
- 3 Director positions:
 - Manage the Associate Program
 - Help with annual events
 - Treasurer/Secretary support

A note of thanks to Ad Hoc Election/Attendance Team: Aiesha, Alexis, Laura, Alpha, and Kate

2 Board positions became open President & VP

Current Members are running & Alexander Dvorak is running for VP



Anyone wishing to nominate themselves for any position, please do so
Anyone wishing to nominate another member, please make a proposal
Any nominated members can make a short statement
Above are the winners of the election



October 22, 2023
ROOSEVELT ISLAND GARDEN CLUB
Members'
VOTING BALLOT
One vote per plot

Please vote for one person for each of the seven elected offices on the RIGC Board. Make a check mark next to the name of the person that you choose.

Office	Candidate	or	Write in Alternative
President	.Ali Schwayri	<input checked="" type="checkbox"/>	<input type="checkbox"/>
Vice President	Alexander Dvorak	<input type="checkbox"/>	<input type="checkbox"/>
Secretary	Julia Ferguson	<input type="checkbox"/>	<input type="checkbox"/>
Treasurer	Takelu Gross	<input type="checkbox"/>	<input type="checkbox"/>
Director - a	Carolina Trujillo	<input type="checkbox"/>	<input type="checkbox"/>
Director - b	David Nisthaus	<input type="checkbox"/>	<input type="checkbox"/>
Director - c	Kristin Caretenuto	<input type="checkbox"/>	<input type="checkbox"/>

President's Report



We regret to share the tragic news, the passing of

Katarina Devaux (C57)

Katarina was only 35 yrs old when she accidentally drowned while snorkeling in the Dominican Republic during a vacation cruise on August 1st this year. She had her whole life ahead of her with a new permanent job teaching at Hunter Elementary.

Our heart felt condolences go out to Carole and her son Dalkeith.



Carmel Calvin (C43)

- Effective the end of this year, Carmel has elected to give up her plot and become a Legacy Garden Associate
- Carmel has been a member of our garden club since 1987, from when we were behind the subway station
- Carmel will be moving to Virginia to live with her daughter. We will miss her greatly.
- She will keep her key and she look forward to her visits to the garden so she can sit and read.

Things we did in 2023



- We added new benches
- Began work on the front common area
- Added 8 planters around the base of cottonwood tree
- Completed the installation of the Cobblestones at entrance
- Designed new: Welcome signs and new: Visitors sign
- Display window on Main Street
- Hosted the Museum of Natural History
- We appeared in NY Times
- Added more planting space in section E
- Installed the Rose Garden irrigation system
- Replaced old wooden borders
- The Great Shopping Expedition
- Tree walk with Schuyler Borden
- Earth Day planting with RIOG in RiverWalk Commons
- Student visits, education and supported iDig2learn





We got more stuff

- Wood from Lowes for borders
- A set of new plyers
- A lawn edge trimmer
- Donation of a hygrometer
- Donation of a new composter
- A new pump for the pond



We expanded planting space in the E plots

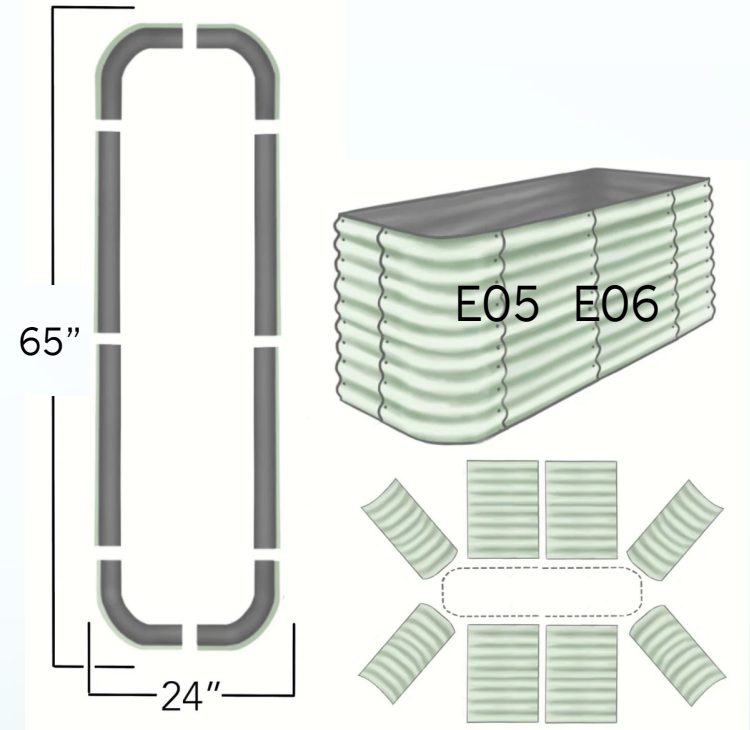
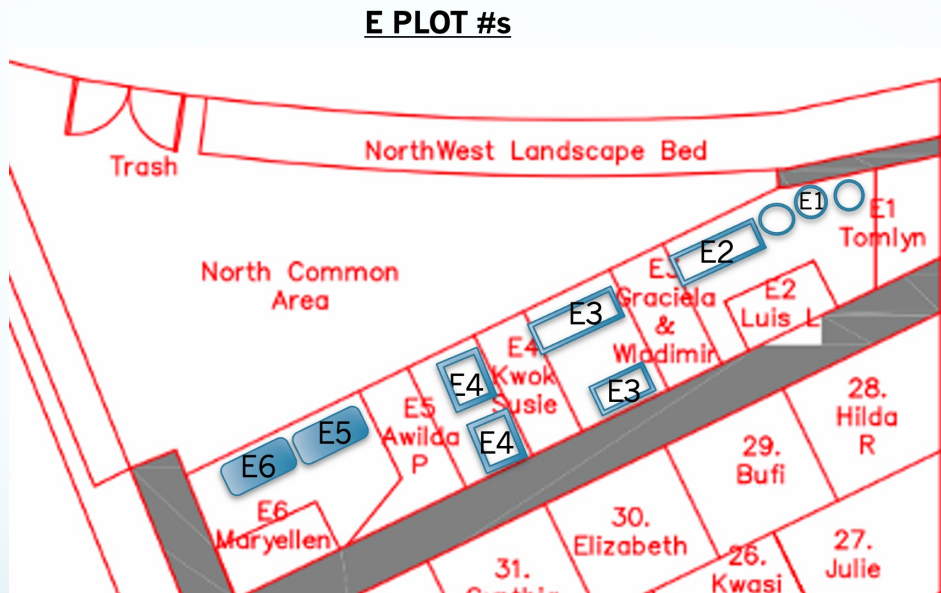

planting expansion will continue



Garden Club was featured in June 14, 2023 issue of New York Times

Spotted Lanternflies Are Back. You Should Still Kill Them.

The battle continues against the colorful bugs, which may be coming for your wine. Here's how New Yorkers can help curb the infestation.

By Asmaa Elkeurti



A night with the Museum of Natural History

We hosted an evening study on fireflies (7/5/23)



The Garden is Life

- Netflix 4 part series: **Live to 100, Secrets of the Blue Zone** by Dan Buettner
- Okinawa, Sardinia, Nicoya, Singapore, Loma Linda, Albert Lea
- What do these places have in common that can lead to long healthy life?
- Go vegetarian, eat till your 80% full, be joyful with friends
- Gardening was identified often. Active daily gardening is like a free gym membership
- Walking: Walk to garden, walk in the garden, and do hand labor
- Bending over, reaching out to your plants is like yoga
- Community Service offers the right level of stress that can lead to rewarding accomplishments
- Be that person who brings smiles to those around you
- Do all this, get in the zone and live to 100

Vice President's Report

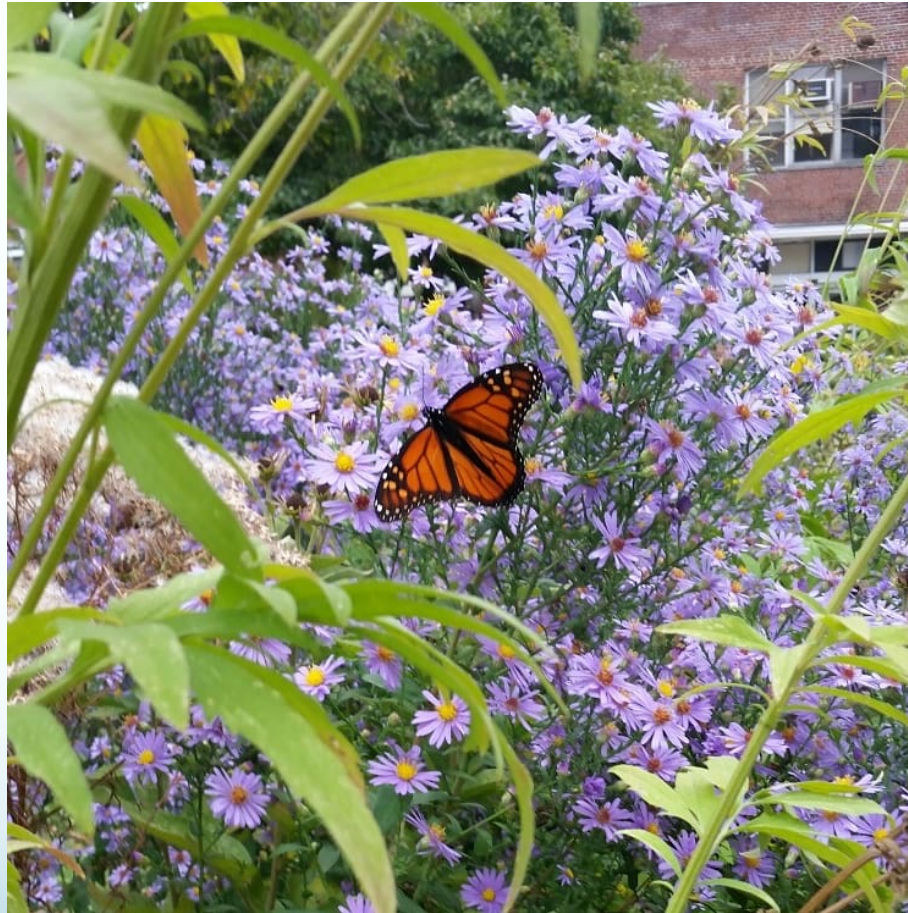



Member	Plot #
Laura Laderman	B 04
Xinyi (Cathy) <u>Guo</u>	B 33
Victoria Thorson	C 30
Sylvain <u>Descoteaux</u>	C 48
Bonnie Cordova	C 60
Francine Benjamin	E 01

External Waitlist

In Spring 2023, there were **166** people on the waitlist; now there are **194 people**. In 2023, **8** plots were available for new members.





Reporting your Community Service

- Reporting your service:
 - We ask you to keep track and report your hours.
 - After the last Community Service Day, Saturday November 11, we will send all Members and Associates an email asking you to report your 2023 service hours.

Community Service Reporting



YES NO: I contributed 3 or more hours of community service (time spent on RIGC activities not related to your own plot).

Please list approximate dates and activities. If you did not contribute to community service, please explain why.

Activities and dates:





Community Service Days

- Members are expected to contribute **at least 3 hours** of community service each year
- Get 3 hours credit--Be a co-chair to work with VP, help with registration/sign-in, bring snacks

Come join us on our final 2023 Community Service Day!



***Saturday, Nov 11th
10 AM to 2 PM***



Self-Directed Community Service

- Alternative/in addition to Community Service Days
- Members can work at their own pace, on their own, and get credit for the hours they put in
- Does not include work in your own plot or paths
- Located in shed, on wall by the tool rack
- Take a photo for your records

COMMUNITY SERVICE SELF ASSIGNMENT SIGN-IN SHEET

Spring / Summer 2023

TASK LIST - Typical things that need to be done:

*Sweep FRONT (SOUTH entrance under large Cottonwood tree) or BACK (NORTHWEST corner by tool sheds) common areas. Put leaves in leaf bins. Put small branches in branch pile. Dispose of any trash in bins.

*Rake pathways. Place leaves only (sift out gravel) in leaf bins.

*Weed pathways beside E plot area and along landscape beds. Separate weeds and place them in the organics compost bin. Replace any gravel back in the path.

*Clean & organize the community tool shed. Sweep the shed. Remove any dirt from tools, sort tools by type, and clean tool handles with alcohol solution.

*Go "Plogging"! Walk around the outer garden perimeter and pick up all trash and dog poop. Place in public trash cans nearby.

* Volunteer Active Projects. Under supervision from committee leaders help with composting, rose garden, maintenance, landscape borders, outreach event, or standards, pest control. Write rigardenclub@gmail.com to find out more.

INSTRUCTIONS FOR SIGN-IN SHEET

In addition to community service days, members can also work for community service credit at their own convenience.

Just print and sign your name below with your plot #, date, start and finish time, and total hours (round to the nearest 15 minutes).

Work will be credited to your account to meet (or exceed) the 3 hour minimum community service requirement yearly for all members.

IMPORTANT--Please be sure to write in what you accomplished to receive community service credit for your time!

PLEASE NOTE: work within individual gardens does NOT qualify as community service, NOR does weeding the path in front of your garden.

Print First NAME	Print Last NAME	SIGNATURE	PLOT #	MM/DD/YY Day	Start Time	Finish Time	Duration (Hrs)	What did you accomplish?



Town Halls Report: May 20 & September 30

The idea of having Town Halls came from the RIGC Engagement & Leadership Task Force convened in 2021. THANK YOU!

May 20th:

- Native plant discussion and plant giveaway
- Shared stories and gardening tips



September 30th:

- Zero-waste potluck, 20+ in attendance
- Organized by Karen Lee
- Janet Linville presented info on invasive plants
- Good food and connections
- Less than 2 oz. landfill waste generated!

Secretary's Report

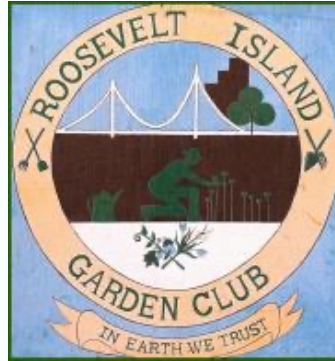

- Our mission statement is important !
- We are a beautiful shared patchwork quilt.
- We are all neighbors and all volunteers.
- Thank you for getting involved with our community garden!

The 2022-2023 CCNYC Grant explained:

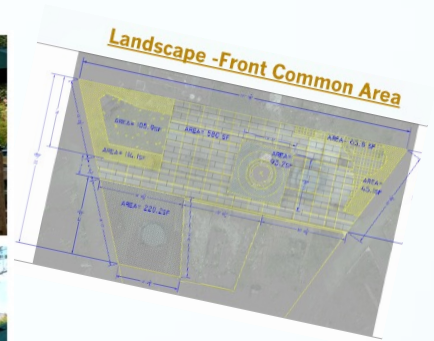

ROOSEVELT ISLAND GARDEN CLUB

Open to the public on weekends
April 15th — October 15th
9:00 AM to 7:00 PM

Welcome to the Roosevelt Island Community Garden.
Come experience nature, hear birds,
and smell the flowers and herbs.
Take pictures, but please do not take anything else.
Be respectful of what our gardeners and
nature have created.

Stay on the paved and gravel pathways.
Do not enter individual members' plots.

Visitors are welcome to enjoy the common area,
rose garden, compost area, John's pond, and
the benches along the main pathways.

www.rigarden.org

New Welcome Sign



Welcome sign in 4 locations



New: Visitor Sign 42" x 24"

Welcome to the

ROOSEVELT ISLAND GARDEN CLUB

A Community Garden



Where to visit:

Rose Garden
Common Area
John's Pond
Composting Area

Stay on paved and gravel pathways.
Do not enter members' plots.
Enjoy the benches along our
perimeter borders.



Life in the Garden:

This garden is a Certified Wildlife Habitat® with the Natural Wildlife Federation.
Enjoy this ecosystem alive with birds, like robins, song sparrows, and catbirds;
amphibians like garden toads, green frogs; and beneficial insects like fireflies,
bumblebees, and butterflies.



Our gardeners create carefully designed flower beds and gardens with vegetables, fruits,
herbs, native plants, and rock formations. These gardens reflect the international diversity
of our community.



History:

We have been an all-volunteer
community garden since 1975.
Working jointly with the Roosevelt Island
Operating Corporation and other organizations,
RIGC contributes to conservation projects and
is recognized as an integral part of this island
community. Incorporated in 1987, we relocated
three times until 1993, when this site became
our home.

Our Mission Statement:

The Roosevelt Island Garden Club is a diverse
community of gardening enthusiasts who work
together to beautify our Roosevelt Island home,

to increase gardening knowledge and to impart
an appreciation for nature and environmental
stewardship among our members and our neighbors.

For more information or to donate to our
501(c)(3) nonprofit, please visit rigarden.org



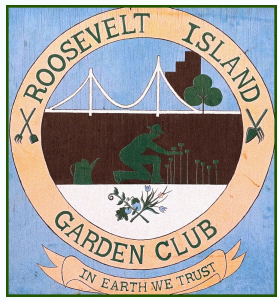

CCNYC Grant's itemized expenditure

<u>COSTS COVERED BY THIS 2022-2023 GRANT</u>	\$3,000.00
Adhesive for Belgian blocks	57.55
Design Wild Consultation	550.00
Materials for spigot and Water pipe move	25.26
Umbrellas x 2 & Planters x 8	305.04
Adirondack Chairs x 2	468.00
External Front Gate Sign <u>Vacker Signs</u>	577.00
Internal Visitors Info Sign Angled <u>Vacker Signs</u>	1,158.00
Total	3,140.85

Treasurer's Report

- Due our use of the \$3,000 of grant money from 2022 and due to our careful spending and accounting, our current 2023 income exceeds our current 2023 expenses...but we anticipate more spending before December 2023 ends.
- We have savings in our account in case of plumbing needs for possible repair work on borders. We will need to purchase special trail mix gravel next year for the Rose Garden, Front Common Area, and Pathway repairs.
- Next year our annual dues will be raised only slightly to continue to work on our savings for infrastructure repairs for our 30-year-old site.

New Update:

	<u>2023</u>	<u>2024</u>
▪ Membership fees	\$60	\$65
▪ Associate fee:	\$25	\$25
▪ Locker fee:	\$25	\$25
▪ Keys:	\$ 5	\$ 5



Associate Members Program

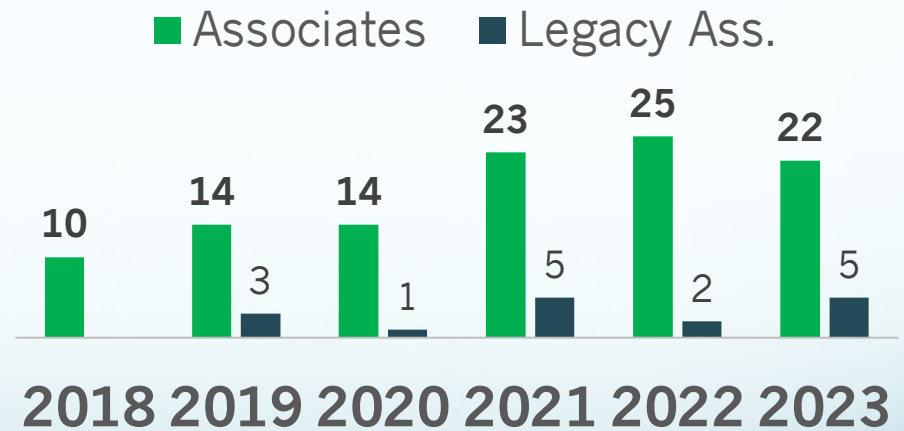



Great Associates & volunteers' contributions in 2023

- Front garden entrance border repair
- Cotton wood area on going reform
- Community service day tasks
- Help to many plot holders in need
- Outreach/learning garden activities
- Participation in ad-hoc committees

Thank you

Melanie
Katherine
Talat
Danilo
Chris
Sid
Amy-Lauren
Schuyler
Kalin
Rachel
Murray
Matthew
Michael
Jonathan
Malika
Irina
Adele
Conor
Annavaletia
Alesha
Froukie

Spotted Lanternfly



EARLY NYMPH

Seen from May until July



LATE NYMPH

Seen from July until September



ADULT-WINGS FOLDED

Seen from July until December

Spotted Lanternflies Eggs

Uncovered egg mass



Partially covered egg mass



Covered egg mass



Old hatched egg mass



Spotted lanternflies are laying eggs right now through the end of the year.

If you spot them, make sure you kill the eggs before they hatch next Spring

They are on any hard surface: trees, rocks, bench, cars....

Scrap the eggs off with a plastic card, crush them or drop in a plastic bag with hand-sanitizer

In the Spring Kill the Spotted Lanternflies

Now is the time to go after the eggs but in the Spring
Kill them when they are in the small nymph stage

The **Vacuum** is in the communal shed

Sprayer bottle is in the Pest Control cabinet near the rear shed

A diluted Dish Liquid (ex: Palmolive) with water in a spray bottle is an effective way to eliminate them.
Add about 3 tablespoons to almost 95% of water. Fill with water first then add dish liquid.

We will need more members to join this small ad hoc committee next year

Next Spring

Anyone interested in raising
domestic Praying Mantises?
The club might fund it.
Contact the board if you or
your children are interested.

USMantis will sell them

Ad Hoc Rat Patrol Team



Score
Total/2023
38/05

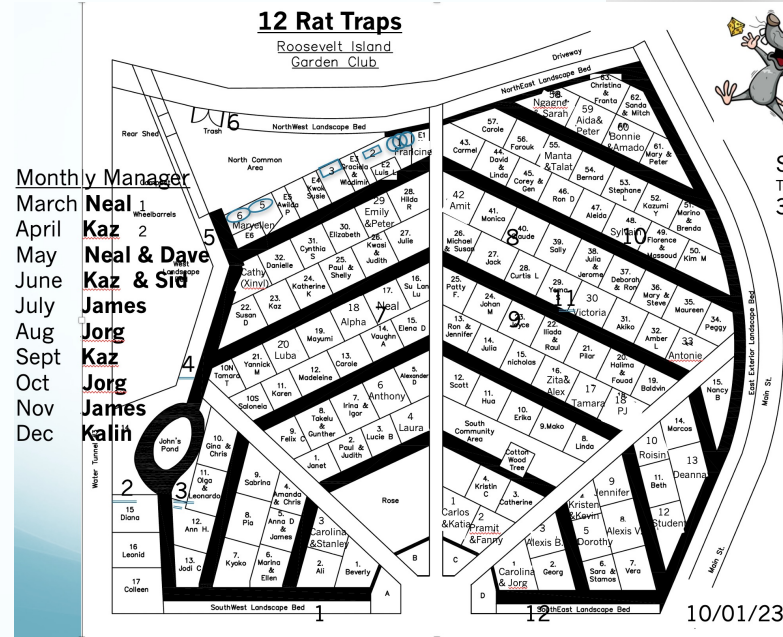

We wish to thank those brave members who took on the thankless task of combating our rodent issue for the past few years

RIOC continues to employ a contractor to manage the outer perimeter of our garden & elsewhere on the island

However this Ad Hoc committee will come to a close and will not return next year

Rats on the island have not gone away, but we will choose to declare **victory** as we have seen a significant reduction of catches in our non-poisonous snap traps and less sightings

THANK YOU!

Kaz, James, Jorg, David, Kalin, & Sid

TRASH GUIDELINES:

Thank You! for carrying out what you carry in.



All recyclables should go home to our building recycling systems. We are all volunteers working together and we must pay RIOC for the trash pick up below.

---WEEKLY: Our TWO GRAY BINS go on Sunday evening for RIOC pickup on Monday morning. These are reserved for rose cane cuttings, diseased plants, invasive weeds, a small amount of miscellany. Help out by rolling bins to the curb.

---BI-WEEKLY: We can only put out 1 Cu Yard for Bulk Pickup by RIOC. This is reserved for used boards, wire tomato cages, broken bricks and pavers, large plant roots.

**Please contact the Board if you have any Bulk items.
(If in doubt, give a shout!)**

Sharing a Gift

- We have 6 sets of 3 tickets each for Free Admission to the:

Museum of Natural History

which includes the **Butterfly Vivarium** and the **Invisible Worlds Theatre** (a \$105 Value)

Tickets are pre-time stamped for Saturday: **November 4th at 10:30am**

- The winners will be randomly selected from Members & Associates in attendance at tonight's meeting
- 3 Hat drawings from a list of very active members
- 3 Hat Drawing from all attendees in tonight's meeting
- And the winner is....

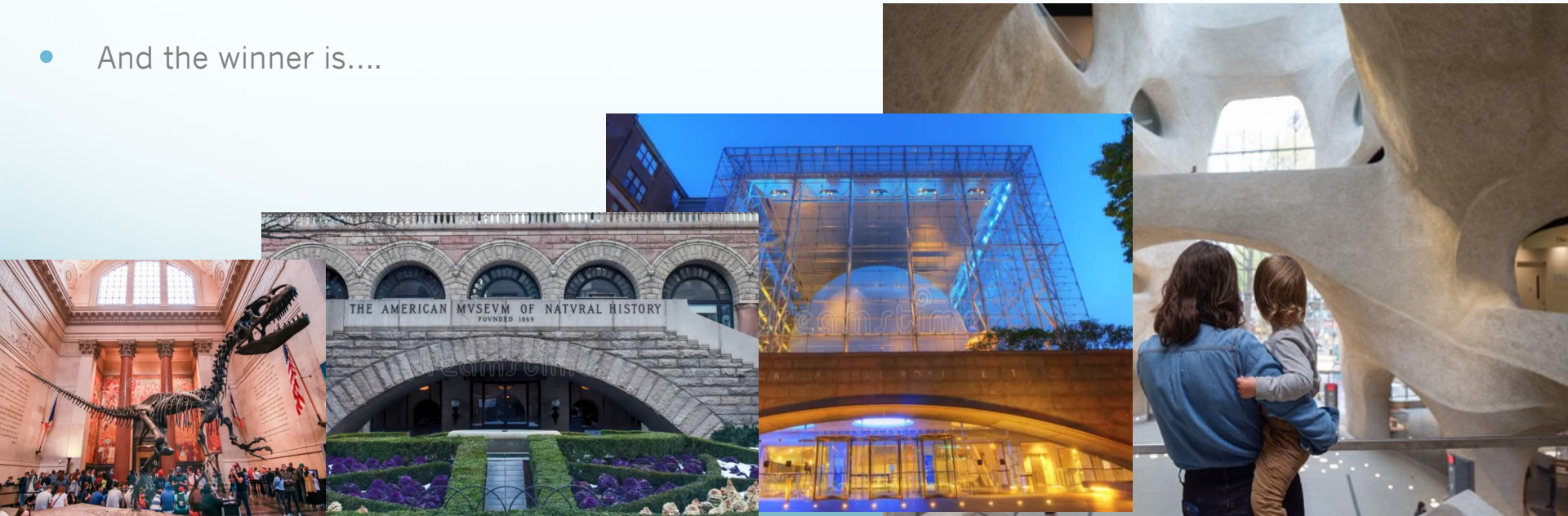

Committee Chair Reports

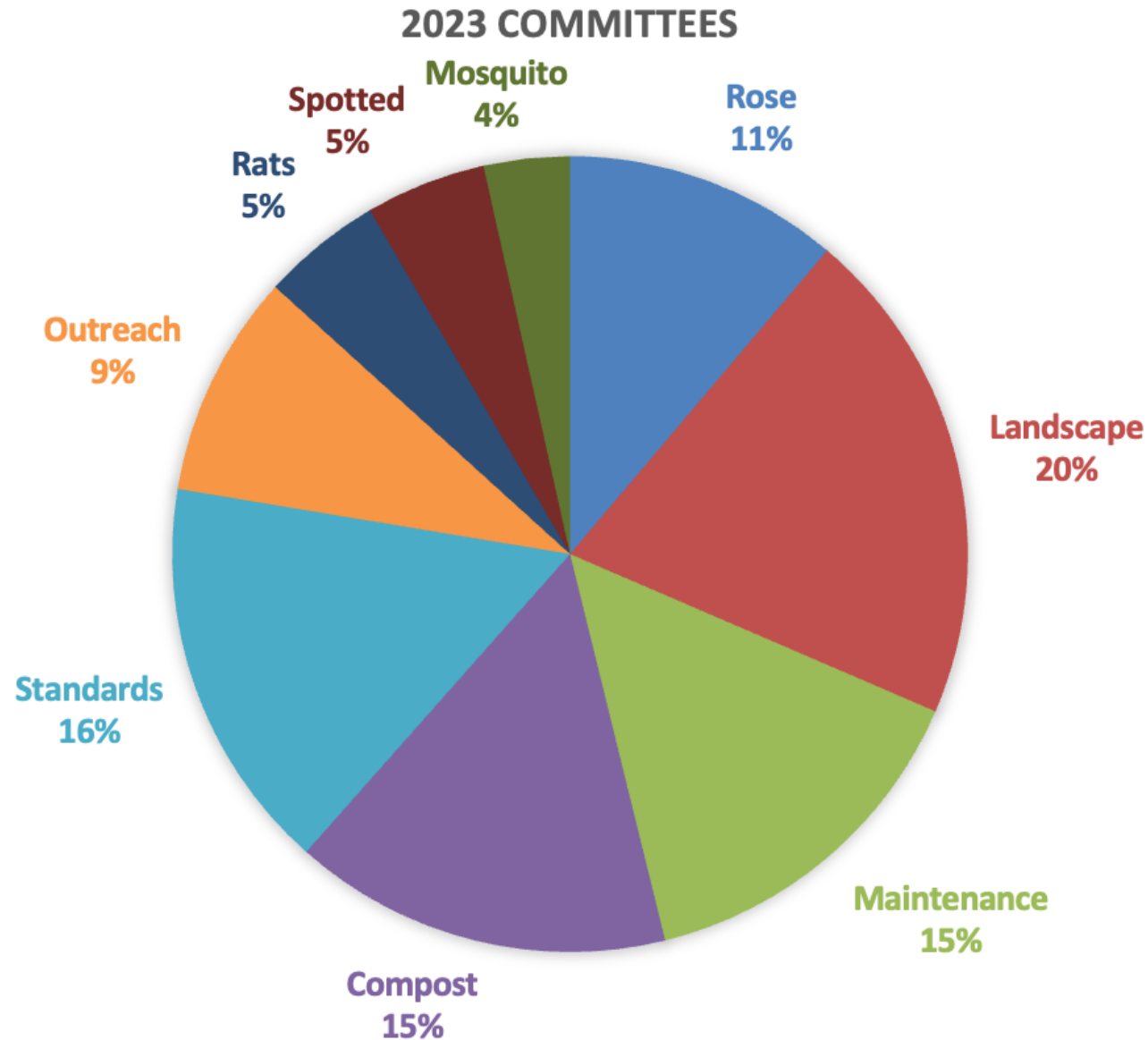

RIGC Outreach & Publicity

Website, Instagram, News, Signage, Volunteers, Visits, Education, Community



Window Display, Photos, Newsletters, Signage:

Visits: Girl Scouts, PS 217 Students, AMNH firefly film crew, Island Kids classes by iDig2Learn, Garden Kids gatherings,

Connections:

RIOC for Habitat gardens in Rivercross Commons and Cherry tree site, iDig2Learn, NYC Pollinators, Big Reuse, Haki Compost

Volunteering:

High School Students, Individuals adults

Events: Plant share, Habitat Planting, Lectures, Earth Day, The Great Pumpkin Nov. 4th



Outreach: Rivercross Window Display

- Our Community Garden was on Display on Main Street!
- May 15th – June 30th



Outreach: We helped RIOC with [Riverwalk commons plantings for Earth Day in April w/ RIOC](#),
[We also hosted Daisy Girl Scouts and a Field Trip with UNIS Environmental Club students](#).

Riverwalk Commons: Earth Love Day in April with RIOC, Daisy Girl Scouts, UNIS MS Field Trip



Thanks to Christina we welcomed several P.S. 217 tours of the garden for all their Kindergarten classes last spring and this summer we provided space for several Island Kids nature classes with iDig2Learn.



Standards Committee

2023 Inspection Schedule

Dates of inspections:

- May 21st
- June 25th
- July 29th
- Sept 17th



Invasive Plants

- These weeds are present in our community garden and need to be properly addressed
- These **NYS invasives** are all aggressive, they will displace our native plants and deprive our native wildlife, like birds and good insects of needed food
- They spread easily by seed and by roots to your neighbor's plot
- Do not compost; carefully remove and place in trash bins
When you remove greens from your garden separate them into 2 piles: Compostable and invasive weeds
- If a gardener would like a native replacement plant the club would be happy to help support this
 - Japanese Knotweed
 - Purple Loosestrife
 - Virgin's Bower (Sweet Autumn Clematis)
 - Mugwort
 - Lesser Celandine
 - Porcelain Berry

Your Garden is the Award

Julie Lipp wins a certificate
for her consistently
excellent garden
Plot B27





RIGC'S Community Compost System

"In Earth We Trust"

What comes from the earth returns to the earth. We compost at least 30,000 pounds of organic materials each year due to amazing member volunteers!

- **Bring GREEN & BROWN ORGANIC PLANT MATERIALS to this chicken wire bin only.**

- All rose canes, invasive plants (bindweed, knotweed, celandine), and diseased plants must be trashed in gray trash bins.
- Branches larger than your finger that cannot be broken easily belong in the Branch Pile near the bamboo thicket.



- **Food scraps can go in these tumblers only.**

- **A core Compost Team works on the big piles and the side bins**

(Anthony, Kaz, Jorg, Julia)



- Watch for the **SIFT ME** sign for sifting availability
- **Come out on a CS days and weekends for a Compost guide** and system learning

A decorative border of various tropical leaves, including monstera and palm fronds, in shades of green, framing the central text.

Add to Compost

**Plants, Leaves, Grass Clippings, Small Twigs,
Egg Shells and their paper carton,
Coffee Grounds, Tea Leaves,
Fruits, Straw, Hay, Pine Cones and Pine Needles**

Don't add to Compost

**Meat, Bones, Fish, Baked goods, Oils,
Rose branches, Sawdust from treated wood,
Plastic, Metals, Glass, Bricks, Stones, Gravel,
Pesticide Treated Plants, Diseased Plants,
Aggressive Weeds, Invasive Weeds and Poop**

Maintenance

- Border work in plots: C03, C04, C08, C09, C10, C11, C12, and C26, C50, C51, & C60
- Gates repaired: A11, E04; Hose Stand installed: B32, D05
- Front Common Area is a work in progress
- Widened pathway, repositioned spigot, new borders, and a leak repaired



Front Common Area – New Borders

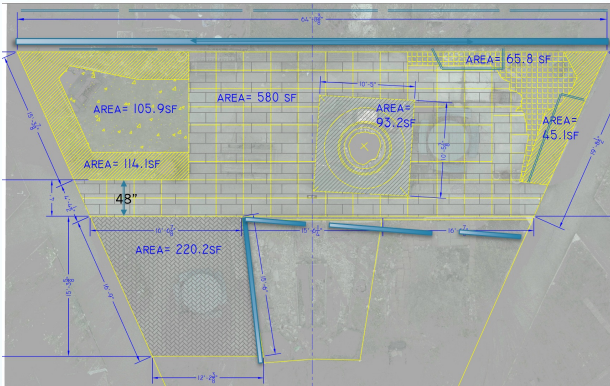

RIGC Landscape & Common Areas

Spring and Early Summer Pictures 2023

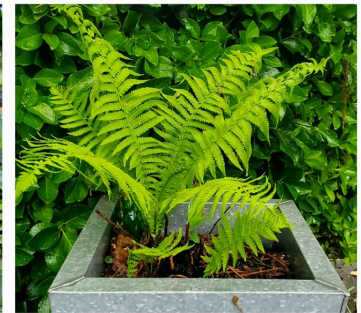

RIGC Landscape & Common Areas

Current fall scenes from Southwest and Southeast beds

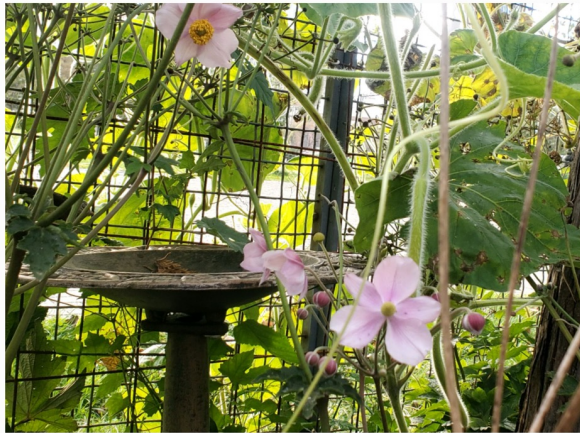
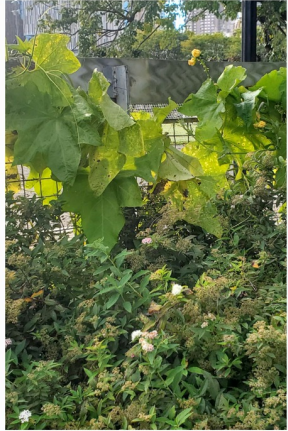

RIGC Landscape & Common Areas

Current fall scenes from North and West beds

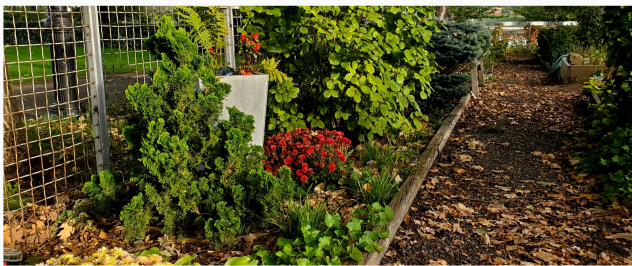
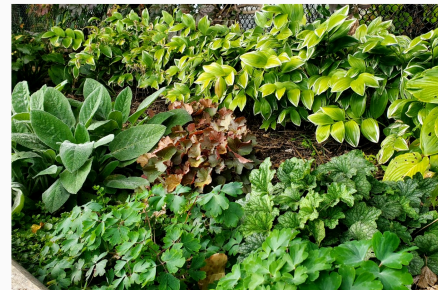

RIGC Rose Garden Report



Roosevelt Island

Rose Garden 2023





The Rose Garden is looking good

- Irrigation system installed
- by Sosa Irriscape Corp.
- Installed 3/21/23
- Water soon be turned OFF for the season

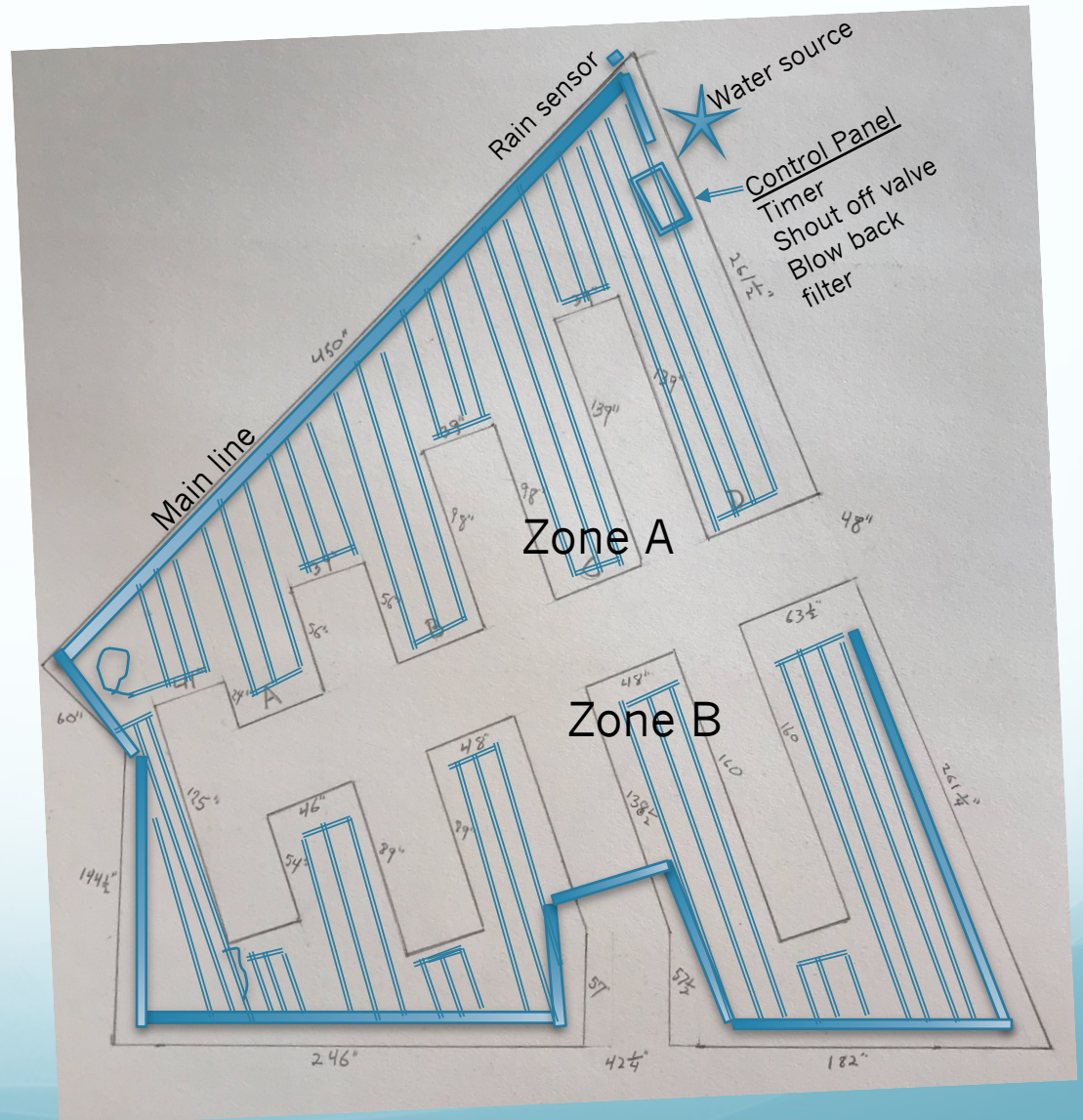

New Business

- Christina Delfico announced and invited all to join two wonderful upcoming events: the Great Pumpkin Event on Sat. November 4th and Stop 'n Swap on Sat. November 11th at Senior Center.
- Julie Lipp reminded all that we do not “own” these plots and that many people are on the waitlist. She suggested RIGC change the rules to be able to quickly kick out more gardeners who are not gardening actively. She suggested that RIGC become tougher and gave the idea that perhaps only 2 LOV letters in one year would equal loss of membership.

End of Spring Meeting



Next Full Membership Spring Meeting
March 17th, 2024
Sunday at 6:45pm (7:00pm)

